



STANDBY 150 kW CONTINUOUS 150 kW

60 Hz

Caterpillar is leading the power generation marketplace with Power Solutions engineered to deliver unmatched flexibility, expandability, reliability, and cost-effectiveness.

FEATURES

FULL RANGE OF ATTACHMENTS

- Wide range of bolt-on system expansion attachments, factory designed and tested

SINGLE-SOURCE SUPPLIER

- **Fully Prototype Tested** with certified torsional vibration analysis available

WORLDWIDE PRODUCT SUPPORT

- Worldwide parts availability through the Caterpillar dealer network
- With over 1,200 dealer outlets operating in 166 countries, you're never far from the Caterpillar part you need.
- 99.5% of parts orders filled within 48 hours. The best product support record in the industry.
- Caterpillar dealer service technicians are trained to service every aspect of your electric power generation system.
- Preventive maintenance agreements
- The Cat Scheduled Oil Sampling (S•O•SSM) program cost effectively detects internal engine component condition, even the presence of unwanted fluids and combustion by-products



CAT® G3406 NA GAS ENGINE

- Reliable, rugged, durable design
- Field-proven in thousands of applications worldwide
- Low pressure gas



CAT SR4B GENERATOR

- Designed to match performance and output characteristics of Caterpillar engines
- Optimum winding pitch for minimum total harmonic distortion and maximum efficiency
- Segregated AC/DC, low voltage accessory box provides single point access to accessory connections



CAT CONTROL PANELS

- Two levels of controls, designed to meet individual customer needs:
 - EMCP II provides digital monitoring, metering, and protection
 - EMCP II+ provides EMCP II features along with full-featured power metering and protective relaying

TECHNICAL DATA

Open Generator Set — 1800 rpm/60 Hz/480 Volts		Standby DM5437		Continuous DM5438	
Package Performance					
Power rating	ekW	150		150	
Power rating @ 0.8 PF	kVA	188		188	
Fuel Consumption					
100% load with fan	N•m³/hr	52	1954	51	1912
75% load with fan	N•m³/hr	42	1584	42	1575
50% load with fan	N•m³/hr	32	1213	32	1204
Cooling System					
Ambient air temperature*	Deg C	40	105	40	105
Air flow restriction (system)	kPa	0.12	0.5	0.12	0.5
Air flow (maximum @ rated speed for standard radiator arrangement)	m³/min	393	13,887	393	13,887
Engine coolant capacity with radiator	L	53	14	53	14
Jacket water outlet temperature	Deg C	99	210	99	210
Exhaust System					
Combustion air inlet flow rate	N•m³/min	8	310	8	321
Exhaust gas stack temperature	Deg C	639	1182	627	1161
Exhaust gas flow rate	N•m³/min	9	1080	9	1102
Exhaust flange size (internal diameter)	mm	127	5	127	5
Exhaust system backpressure (maximum allowable)	kPa	6.7	27	6.7	27
Heat Rejection					
Low Heat Value (LHV) fuel input	kW	527	29,953	515	29,306
Heat rejection to jacket water (includes oil cooler)	kW	193	10,994	178	10,146
Total heat rejection to exhaust (LHV to 25° C)	kW	140	7965	144	8192
Heat rejection to exhaust (LHV to 120° C)	kW	117	5932	117	5926
Heat rejection to atmosphere from engine	kW	21	1198	21	1172
Heat rejection to atmosphere from generator	kW	16	897	16	897
Generator					
Motor starting capability @ 30% voltage dip**	kVA	649		649	
Frame		447		447	
Temperature rise	Deg C	130		105	
Emissions***					
NOx	g/bhp-hr	11.3		21.6	
CO	g/bhp-hr	12.5		1.6	
HC (total)	g/bhp-hr	1.4		2.8	
HC (non-methane)	g/bhp-hr	0.21		0.42	
Exhaust O ₂ (dry)	%	0.5		2.0	

*Ambient capability at 200 m (660 ft) above sea level. For ambient capability at other altitudes, consult your Caterpillar dealer.

**Assumes synchronous driver

***Emissions data measurement is consistent with those described in EPA CFR 40 PART 89 SUBPART D and ISO 8178-1 for measuring HC, CO, CO₂ and NOx. Data shown is based on steady state engine operating conditions of 77° F, 28.43 inches HG and fuel having a LHV of 920 BTU per cubic foot at 30.00 inches HG absolute and 32° F. Not to exceed emission data shown is subject to instrumentation, measurement, facility and engine fuel system adjustments.

RATING DEFINITIONS AND CONDITIONS

Standby — Output available with varying load for the duration of the interruption of the normal source power.

Continuous — Output available without varying load for an unlimited time.

Ratings are based on ISO3046/1 standard reference conditions of 25° C (77° F) and 100 kPa (29.61 in Hg).

Ratings are based on pipeline natural gas having a LHV (low heat value) of 36.2 mJ/N•m³ (920 Btu/cu ft). Variations in altitude, temperature, and gas composition from standard conditions or the use of a three way catalyst may require a reduction in engine horsepower.

S T A N D B Y 1 5 0 e k W
C O N T I N U O U S 1 5 0 e k W
6 0 H z



STANDBY/CONTINUOUS POWER GENERATOR SET PACKAGE — TOP VIEW



STANDBY/CONTINUOUS POWER GENERATOR SET PACKAGE — SIDE VIEW

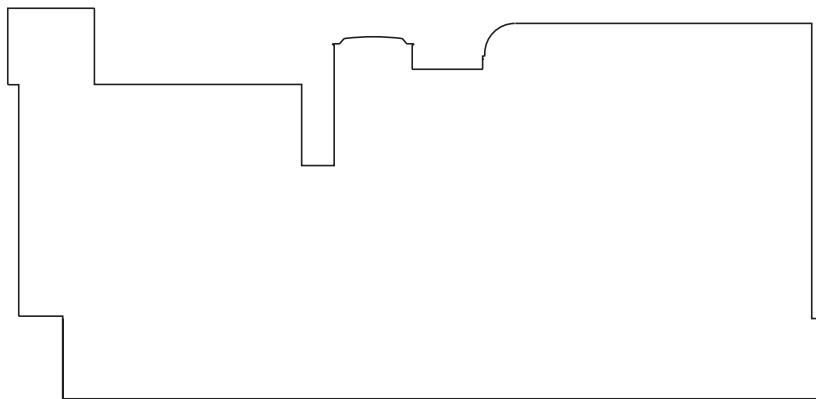

Package Dimensions		
Length	4074 mm	160.39 in
Width	1306.7 mm	51.45 in
Height	2131.9 mm	83.93 in
Shipping Weight	2951 kg	6500 lb

Note: Do not use for installation design.
See general dimension drawings
for detail (Drawing #207-4500).

www.CAT-ElectricPower.com

TMI Reference No.: DM5437, DM5438

U.S. sourced

LEHE1429 (06-01)

© 2001 Caterpillar
All rights reserved.
Printed in U.S.A.

Materials and specifications are subject to change without notice.
The International System of Units (SI) is used in this publication.